

**COUNTY OF LOS ANGELES**

**ROAD DEPARTMENT**

**PRECISE**

**BENCH MARK LIST**



**WATTS QUAD**

**1980 ADJUSTMENT**

P R E F A C E  
1980 Adjustment

The Road Department level net published in 1975 consisted of more than 1500 miles of levels supporting in excess of 18,000 bench marks. For reasons of economy, this 1980 adjustment is reduced to about 55% of the bench marks previously published. Reductions were made by increasing the spacing between level lines in unincorporated territory, and eliminating lines in non-contract cities and areas where the probability of future engineering projects appears slight. The 1980 adjustment is an update of the remainder of the 1975 bench marks, not including baselines. Data from previous adjustments is available without inferring any responsibility for the current reliability of the data or the actual existence of the bench marks. Elevations of bench marks with the same quad name, but different adjustment dates, are not normally compatible.

To facilitate the adjustment, indexing, and distribution of adjusted values of the net, the County territory is divided into 34 quads or areas. For identification purposes each quad is given a name, viz., "Rosemead," "La Mirada," "Santa Fe," etc. When bench marks and elevations in the Road Department net are used, the name of the quad in which the bench mark is located and the date of the elevation adjustment must be included in the bench mark description, e.g.,

CY 6901 - RDEM TAG S CB 11FT E BCR @ SE COR LA CIENEGA  
BLVD & LENNOX BLVD 32FT S & 73FT E C/L INT  
(HAWTHORNE - 1980) ELEV. 82.549

The precision of the net is reflected by an indicated field probable error of plus or minus 0.012 foot per mile of leveling as determined from over 300 conditions of closure. However, many years experience in vertical control in the greater Los Angeles basin and Antelope Valley indicate that because of varying degrees of subsidence and heaving, the true datum is recovered only by obtaining substantial agreement between a number of bench marks.

The users of this net are invited to assist in its maintenance by notifying this Department of cases of obliteration, apparent mistakes in descriptions or elevations, and proven disturbance of bench marks.

---

DATUM: U. S. Coast and Geodetic Survey Sea Level Datum  
of 1929, through the medium of the Los Angeles  
County Engineer Precise Level Net.

ABBREVIATIONS USED IN BENCH MARK LISTINGS

ABUT - - - - -	Abutment	EC - - - - -	End of Curve
ALG - - - - -	Along	ENT - - - - -	Entrance
ANG PT - - - - -	Angle Point	FL - - - - -	Floor
B/W - - - - -	Back of Walk	FTG - - - - -	Footing
BCR - - - - -	Beginning of Curb Return	FRWY - - - - -	Freeway
BC - - - - -	Beginning of Curve	F/W - - - - -	Front of Walk
BLDG - - - - -	Building	GAR - - - - -	Garage
EM - - - - -	Bench Mark	HDWL - - - - -	Headwall
BT SPK - - - - -	Boat or Bolt Spike	HSE - - - - -	House
BR CAP - - - - -	Brass or Bronze Cap	HWY - - - - -	Highway
C B - - - - -	Catch Basin	INT - - - - -	Intersection
CTR - - - - -	Center	IP - - - - -	Iron Pipe
C/L - - - - -	Center Line	LT - - - - -	Left
C/L INT - - - - -	Center Line Intersection	LACE - - - - -	L. A. City Engineer
C/L PROD - - - - -	Center Line Produced	LACS - - - - -	L. A. Co. Engineer
CONC - - - - -	Concrete	LAFC - - - - -	L. A. Co. Flood Control
COR - - - - -	Corner	L&BN - - - - -	Lead and Bench Nail
COE - - - - -	Corps of Engineers	L&BR - - - - -	Lead and Brad
CULV - - - - -	Culvert	L&N - - - - -	Lead and Nail
CYN - - - - -	Canyon	L&SPK - - - - -	Lead and Spike
CB - - - - -	Curb	L&T - - - - -	Lead and Tack
CS MON - - - - -	Co. Engineer Monument	MCR - - - - -	Middle of Curb Return
CT SPK - - - - -	Cut Spike	MKD - - - - -	Marked
DR - - - - -	Drive or Driveway	MC - - - - -	Middle of Curve
E/O - - - - -	East of	MON - - - - -	Monument
ECR - - - - -	End of Curb Return	N/O - - - - -	North of

ABBREVIATIONS USED IN BENCH MARK LISTINGS . . . CONTINUED

NR - - - - - Near  
OPP - - - - - Opposite  
PI - - - - - Point of Intersection  
PK&W - - - - - PK Nail and Washer  
P/L - - - - - Property Line  
POST - - - - - Point on Semi-Tangent  
PP - - - - - Power Pole  
PVMT - - - - - Pavement  
PROD - - - - - Produced  
RD - - - - - Road  
RDEM - - - - - Road Dept. Bench Mark  
RDEM TAG - - - - - Road Dept. Bench Mark Tag  
RR - - - - - Railroad  
RT - - - - - Right  
R/W - - - - - Right of Way  
SDMH - - - - - Storm Drain Manhole  
SMH - - - - - Sewer Manhole  
SPK - - - - - Spike  
ST&W - - - - - Spike Tin and Washer  
S/O - - - - - South of  
TP - - - - - Telephone Pole  
USC&GS - - - - - U. S. Coast and Geodetic Survey  
USGS - - - - - U. S. Geological Survey  
WK - - - - - Walk  
W/O - - - - - West of

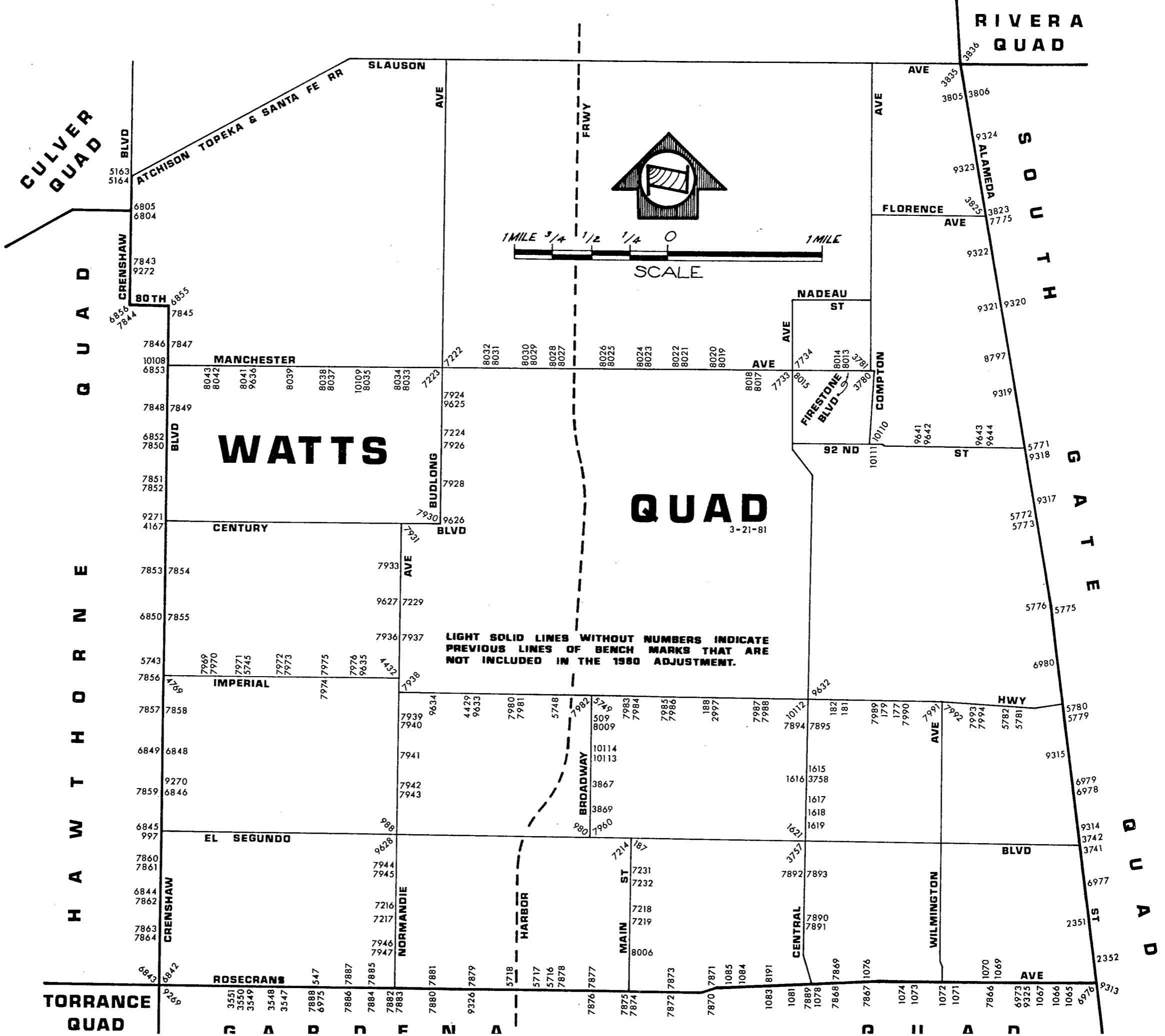

**CULVER  
QUAD**

**RIVERA  
QUAD**

**QUAD**

**S O U T H  
G A T E**

**H A W T H O R N E  
QUAD**

**G A T E**

**TORRANCE  
QUAD**

**W A T T S  
QUAD**

**QUAD**

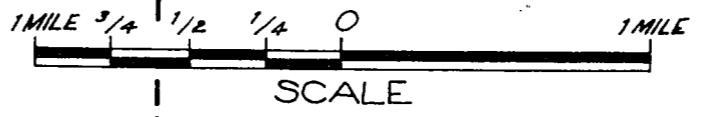

LIGHT SOLID LINES WITHOUT NUMBERS INDICATE  
PREVIOUS LINES OF BENCH MARKS THAT ARE  
NOT INCLUDED IN THE 1980 ADJUSTMENT.

**QUAD**  
3-21-81

QUAD-YEAR	ELEV	DESCRIPTION (INCLUDE QUAD AND YEAR IN DESCRIPTION)	BM NUMBER
WATTS (1980)	93.349	FLT HD SPK S CB 40FT S C/L IMPERIAL HWY @ C/L PROD GRANDEE AVE	CY 177
WATTS (1980)	92.882	LA CITY ENG HEX MON IN WELL 14IN DN ON C/L IMPERIAL HWY 25FT W C/L COMPTON AVE TO N	CY 179
WATTS (1980)	93.422	L&BN S CB 3FT W BCR 40FT S C/L IMPERIAL HWY & 40FT W C/L SUCCESS AVE	CY 181
WATTS (1980)	93.926	L&BN S CB 3FT W BCR 40FT S C/L IMPERIAL HWY & 35FT W C/L PARMELEE AVE	CY 182
WATTS (1980)	134.576	RDBM TAG N CB 1FT W BCR @ NW COR EL SEGUNDO BLVD & MAIN ST 66FT W & 40FT N C/L INT	CY 187
WATTS (1980)	110.586	RDBM TAG W CB 1FT S BCR 61FT S & 30FT W C/L INT IMPERIAL HWY & AVALON BLVD	CY 188
WATTS (1980)	152.253	L & T IN W CB 42FT N & 21FT W C/L INT BROADWAY & 117TH ST ON C/L PROD 116TH PL	CY 509
BASELINE (1975)	47.297	L&T 1FT N BCR @ NE COR WESTERN AVE & ROSECRANS AVE 40FT E & 65FT N	CY 547
WATTS (1980)	147.152	RDBM TAG N CB 1FT W BCR @ EL SEGUNDO BLVD & BROADWAY 40FT N & 74FT W C/L INT	CY 980
WATTS (1980)	122.632	RDBM TAG N CB 1FT W BCR @ NW COR NORMANDIE AVE & EL SEGUNDO BLVD 38FT N & 56FT W C/L INT	CY 988
BASELINE (1975)	51.198	LAFC MON 12IN DN 50FT S C/L EL SEGUNDO BLVD & 175FT E C/L CRENSHAW BLVD ON W P/L DOMINGUEZ LAFC CHANNEL MKD (1959-27 75A CD ENGR)	CY 997
BASELINE (1975)	69.674	L & BR @ MCR 43FT N & 37FT E C/L INT ROSECRANS AVE & MONA AVE (E BBL WILLOWBROOK AVE)	CY 1065
BASELINE (1975)	69.747	L&T NR CTR CB RET @ NW COR WILLOWBROOK AVE W BARREL & ROSECRANS AVE 43FT N & 45FT W C/L INT	CY 1066
BASELINE (1975)	69.511	L&T NR CTR CB RET @ NE COR ACACIA ST & ROSECRANS AVE 42FT N & 45FT E C/L INT	CY 1067
BASELINE (1975)	72.114	L&T CTR CB RET NE COR ROSECRANS AVE & ARANBE AVE 43FT N C/L ROSECRANS AVE & 18FT E C/L ARANBE AVE	CY 1069
BASELINE (1975)	72.931	L & BR 7FT W BCR 42FT N & 25FT E C/L INT ROSECRANS AVE & MATTHESEN AVE CTR CB RET	CY 1070
BASELINE (1975)	75.105	L&T CTR CB RET NE COR WILMINGTON AVE & ROSECRANS AVE 46FT N & 40FT E C/L INT	CY 1071

QUAD-YEAR	ELEV	DESCRIPTION (INCLUDE QUAD AND YEAR IN DESCRIPTION)	BM NUMBER
BASELINE (1975)	75.131	L&T CTR CB RET NW COR WILMINGTON AVE & ROSECRANS AVE 45FT N & 40FT W C/L INT	CY 1072
BASELINE (1975)	75.896	CS MON IN WELL 38FT N C/L ROSECRANS AVE & 38FT W OF NW COR CONC BRIDGE OVER COMPTON CREEK 164FT E C/L DWIGHT ST MKD (CS MON BM 21-2-1952 RE 63)	CY 1073
BASELINE (1975)	77.370	L&BN N CB 2FT E BCR @ NE COR ROSECRANS AVE & DWIGHT ST 38FT N & 35FT E C/L INT	CY 1074
BASELINE (1975)	85.084	L&BN IN E CB 69FT S & 23FT E C/L INT ROSECRANS AVE & TAJAUTA AVE 4FT S/O BCR	CY 1076
BASELINE (1975)	100.377	CS MON IN WELL 44FT N C/L ROSECRANS AVE 105FT E C/L CENTRAL AVE 32FT E BCR 4FT N CB MKD (BM 21-3 1952 RE 63)	CY 1078
BASELINE (1975)	105.455	L&BN 4IN S BCR @ SE COR KEENE AVE & ROSECRANS AVE 106FT S & 24FT E C/L INT	CY 1081
BASELINE (1975)	109.907	L & T S CB ROSECRANS AVE SERVICE RD 1FT E BCR 55FT E C/L CAHITA AVE & 76FT S C/L ROSECRANS AVE MKD (BM)	CY 1083
BASELINE (1975)	113.407	L & T IN NW COR HI TENSION TOWER NO 1325 65FT S C/L ROSECRANS AVE & 35FT E C/L STANFORD AVE	CY 1084
BASELINE (1975)	114.105	L&BN N CB ROSECRANS AVE 1FT W BCR @ NW COR ROSECRANS AVE & STANFORD AVE 40FT N & 52FT W C/L INT	CY 1085
WATTS (1980)	91.095	L & S 3FT E BCR 28FT S & 64FT E C/L INT CENTRAL AVE & 120TH ST	CY 1615
WATTS (1980)	90.125	L & BN IN CB @ N END C B 38FT W C/L CENTRAL AVE & 75FT S C/L 121ST PL	CY 1616
WATTS (1980)	89.781	L&BN 1FT N BCR NE COR 124TH ST SERVICE ROAD & CENTRAL AVE (SER RD) 44FT N & 80FT E C/L INT	CY 1617
WATTS (1980)	89.579	L&BN 1FT N BCR @ NE COR 126TH ST SERVICE ROAD & CENTRAL AVE (SER RD) 41FT N & 80FT E C/L INT	CY 1618
WATTS (1980)	89.374	L & BN 1FT N BCR 43FT N & 80FT E C/L INT CENTRAL AVE (SERVICE RD) & 127TH ST	CY 1619
WATTS (1980)	91.356	R D MON IN WELL ON C/L CENTRAL AVE 30FT N C/L EL SEGUNDO BLVD	CY 1621
BASELINE (1975)	72.890	L&T E CB ALAMEDA ST 33FT S OF N CB ORIS ST PRUD	CY 2351

QUAD-YEAR	ELEV	DESCRIPTION (INCLUDE QUAD AND YEAR IN DESCRIPTION)	BM NUMBER
BASELINE (1975)	70.622	L&T E CB ALAMEDA ST ON C/L PROD MEALY ST	CY 2352
WATTS (1980)	108.963	LACE MON IN WELL @ C/L INT IMPERIAL HWY & AVALON BLVD (N OF TWO MON 4FT APART)	CY 2997
BASELINE (1975)	44.896	L&T S CB 1FT E BCR 40FT E & 40FT S C/L INT ROSECRANS AVE & GRAMERCY PL	CY 3547
BASELINE (1975)	44.593	L&T W CB GRAMERCY PL 1FT S OF BCR 18FT W & 60FT S C/L INT ROSECRANS AVE & GRAMERCY PL	CY 3548
BASELINE (1975)	45.068	RDBM TAG 7FT E BCR 40FT S & 75FT E C/L INT ROSECRANS AVE & VAN NESS AVE (IN S CB)	CY 3549
BASELINE (1975)	46.217	RDBM TAG W CB VAN NESS AVE 5FT N BCR 30FT W & 68FT N C/L INT ROSECRANS AVE & VAN NESS AVE	CY 3550
BASELINE (1975)	44.309	CS MON 90FT S C/L ROSECRANS AVE & 30FT W C/L VAN NESS AVE 1.5FT BACK OF CURB	CY 3551
BASELINE (1975)	79.756	BR CAP @ S END W CONC BANNISTER @ MAIN ENT TO THE (FRANCIS WILLARD SCHOOL) 114FT E C/L ALAMEDA ST E BBL & 98FT S C/L EL SEGUNDO BLVD MKD (W 615 1941)	CY 3741
BASELINE (1975)	75.451	CS MON IN WELL 27FT E C/L ALAMEDA ST W BBL & 3FT S C/L EL SEGUNDO BLVD	CY 3742
WATTS (1980)	92.047	BN 2FT S BCR @ SW COR CENTRAL AVE & EL SEGUNDO BLVD 65FT S & 38FT W C/L INT	CY 3757
WATTS (1980)	90.961	L & BN 2FT N BCR 50FT N & 38FT E C/L INT CENTRAL AVE & 121ST ST	CY 3758
WATTS (1980)	128.465	L&T N CB FIRESTONE BLVD 35FT N/O C/L BN C/L PROD COMPTON AVE FROM THE S	CY 3780
WATTS (1980)	129.019	L&T 5FT E/O BCR @ NW COR FIRESTONE BLVD & COMPTON AVE TO N 37FT N & 47FT W/O C/L INT	CY 3781
BASELINE (1975)	175.372	CS MON IN WELL 13FT N/O MOST NLY PE TRACK ON RANDOLPH ST & 12FT W FROM MOST WLY SP RAIL ON ALAMEDA ST 22FT E/O C/L W BBL ALAMEDA ST 11FT S C/L N BBL RANDOLPH ST	CY 3805
BASELINE (1975)	178.691	DISC IN S WALL 2FT E OF THE SW COR & 3FT ABOVE RANDOLPH ST & E BBL ALAMEDA ST 8FT N/O N CB & 8FT E/O E CB	CY 3806
BASELINE (1975)	154.052	L&BN 1FT W BCR @ NW COR W BBL ALAMEDA ST & FLUR- ENCE AVE 30FT N & 60FT W C/L INT	CY 3823



QUAD-YEAR	ELEV	DESCRIPTION (INCLUDE QUAD AND YEAR IN DESCRIPTION)	BM NUMBER
BASELINE (1975)	157.169	CS MON SW COR MILLER GASKET CO BLDG 2FT ABOVE GROUND & 3FT N OF THE BLDG COR 86FT E OF E CB ALAMEDA ST & 1FT N OF THE N CB OF FLORENCE AVE	CY 3825
BASELINE (1975)	179.435	L&BN 2FT E BCR @ SW COR SLAUSON AVE & ALAMEDA ST 34FT S & 43FT W/O C/L INT	CY 3835
BASELINE (1975)	178.983	CS MON C/L SLAUSON AVE 14FT W OF W RAIL SPRR 20FT E C/L ALAMEDA ST MKD ( WATTS H-2A 1939)	CY 3836
WATTS (1980)	173.170	L & T 2FT N ECR 69FT N & 38FT E C/L INT BROADWAY & 124TH ST	CY 3867
WATTS (1980)	154.546	L & T IN W CB 20FT N & 38FT W C/L INT BROADWAY & 127TH ST	CY 3869
BASELINE (1975)	157.190	LACS BM MON IN WELL 2FT BK OF CB & APPROX CTR OF SW CB RET CRENSHAW BLVD & CENTURY BLVD 50FT S & 47FT W/O C/L INT MKD (BM 27-68 1953 RE 63)	CY 4167
WATTS (1980)	197.028	BM TAG N CB 1FT W/O BCR @ NW COR VERMONT AVE ( W BBL ) & IMPERIAL HWY 40FT N & 40FT W/O C/L INT	CY 4429
WATTS (1980)	202.401	L & T @ MCR 42FT N & 44FT W C/L INT NORMANDIE AVE & IMPERIAL HWY	CY 4432
BASELINE (1975)	76.499	FLT HD NAIL S CB IMPERIAL HWY 12FT W BCR @ SW COR CRENSHAW BLVD 36FT S & 85FT W C/L INT	CY 4769
BASELINE (1975)	160.117	USC&GS MON FL 49FT E & 118FT S/O INT CRENSHAW BLVD & 67TH ST 12FT NW OF N RAIL AT&SFRR & 13FT E/O E CB CRENSHAW BLVD MKD ( A-415 1935)	CY 5163
BASELINE (1975)	159.144	USC&GS MON 13IN UP 187FT E & 39FT S/O INT OF CRENSHAW BLVD & 67TH ST & 67FT W/O INT S CB & AT&SFRR MKD ( Z-414 1935)	CY 5164
BASELINE (1975)	99.659	LACE MON IN WELL @ OR NR C/L INT FIGUEROA ST & ROSECRANS AVE MKD (TRAV STA WATTS C 12 B 1946)	CY 5716
BASELINE (1975)	90.464	L & RD HD SPK IN N CB HARBOR FWY OVERPASS 35.5FT W BCR 42FT N C/L ROSECRANS AVE 70FT E C/L FWY	CY 5717
BASELINE (1975)	89.162	L&SPK N CB ROSECRANS AVE 2FT E BCR 159FT W C/L HARBOR FREEWAY OVERPASS & 42FT N C/L ROSECRANS AVE 23FT E C/L HOOVER ST	CY 5718
BASELINE (1975)	79.017	LACS BM MON IN WELL IN PKWY @ N-W COR CRENSHAW BLVD & 113TH ST 26FT N & 45FT W/O C/L INT MKD (BM 27-70A 1960 RE5869)	CY 5743

QUAD-YEAR	ELEV	D E S C R I P T I O N (INCLUDE QUAD AND YEAR IN DESCRIPTION)	BM NUMBER
WATTS (1980)	119.135	L & T 2FT N BCR @ NE COR IMPERIAL HWY & VAN NESS AVE 30FT E & 80FT N C/L INT	CY 5745
WATTS (1980)	135.437	BT SPK E CB 1FT N BCR @ NE COR IMPERIAL HWY & FIGUEROA ST 33FT E & 60FT N C/L INT	CY 5748
WATTS (1980)	141.190	CT SPK S CB 25FT E BCR @ SE COR BROADWAY & IMPERIAL HWY 36FT S & 60FT E C/L INT	CY 5749
BASELINE (1975)	119.713	CS MON CONC FOUNDATION SW LEG TRANSMISSION LINE TOWER NO 26503 33FT E C/L E BBL ALAMEDA ST & 118 FT N C/L SOUTHERN AVE MKD (LC 769 1945)	CY 5771
BASELINE (1975)	111.407	CS MON 12IN DN 60FT N C/L TWEEDY BLVD & 27FT E C/L W BBL ALAMEDA ST MKD WATTS I 7 A 1938	CY 5772
BASELINE (1975)	113.565	RD MON CONC BASE FORMER RR SIGNL 68FT E C/L W BB ALAMEDA ST & 30FT N C/L TWEEDY BLVD MKD (BM 30)	CY 5773
BASELINE (1975)	102.901	CS MON IN CONC POST 2IN UP 1FT E OF E CB ALAMEDA ST W BBL & 199 N C/L CENTURY BLVD MKD (RE 2177-6) USE SE EDGE	CY 5775
BASELINE (1975)	101.968	CS MON IN CONC POST 3FT W OF W CB ALAMEDA ST & 199FT N C/L CENTURY BLVD USE S EDGE	CY 5776
BASELINE (1975)	91.310	LACE HEX MON IN WELL 32FT E C/L ALAMEDA ST W BBL & 34FT S C/L IMPERIAL HWY	CY 5779
BASELINE (1975)	91.188	L&BN 10FT S BCR @ SE COR 25FT E C/L ALAMEDA ST E BBL & 70FT S C/L IMPERIAL HWY MKD (BM)	CY 5780
WATTS (1980)	87.772	L&T S CB 1FT W BCR @ SW COR MONA AVE & IMPERIAL HWY 40 FT S & 30FT W C/L INT	CY 5781
WATTS (1980)	89.213	L&T S CB 1FT E BCR @ SE COR GORMAN AVE & IMPERIAL HWY 40FT S & 33FT E C/L INT	CY 5782
BASELINE (1975)	159.185	LACE HEX BAR MON IN WELL @ C/L INT CRENSHAW BLVD & FLORENCE AVE (26-62 CO ENGR)	CY 6804
BASELINE (1975)	158.248	WIRE SPK W CB 5FT N BCR @ NW COR CRENSHAW BLVD & FLORENCE AVE 60FT N & 38FT W C/L INT	CY 6805
BASELINE (1975)	50.039	LACS BM MON FL IN F C WALL 6FT N/O CB E SIDE CHANNEL 46FT N & 191FT E/O C/L INT ROSECRANS AVE & CRENSHAW BLVD MKD (21-11A 1964 RE 5869)	CY 6842
BASELINE (1975)	49.764	L&BN E CB 1FT N BCR @ NE COR CRENSHAW BL & ROSECRANS AVE 38FT E & 76FT N/O C/L INT	CY 6843

QUAD-YEAR	ELEV	DESCRIPTION (INCLUDE QUAD AND YEAR IN DESCRIPTION)	BM NUMBER
BASELINE (1975)	45.855	LACS BM MON IN WELL 62FT W/O C/L CRENSHAW BLVD & 6FT S C/L PROD 134TH ST MKD (BM 27-76 A 1960 RE 5869)	CY 6844
BASELINE (1975)	49.122	L&BN E CB 6FT S BCR @ NE COR EL SEGUNDO BLVD & CRENSHAW BLVD 63FT N & 40FT E/O C/L INT	CY 6845
BASELINE (1975)	52.652	RDBM BR CAP MON 21IN DN 63FT E/O C/L CRENSHAW BLVD 43FT N/O INT BROADWAY & 28FT N/O C/L P E RR TRACK MKD (RDBM 157)	CY 6846
BASELINE (1975)	57.607	LAFC BR CAP MON SW COR C B ON NE COR CRENSHAW BLVD & DOMINGUEZ CHANNEL 39FT E/O C/L & 143FT N/O INT 120TH ST MKD BM (114 51 1948)	CY 6848
BASELINE (1975)	57.607	L&BN W CB 98FT N/O BCR NW COR CRENSHAW BLVD & 120TH ST 160FT N & 38FT W/O C/L INT 1FT S/O N END OF CB	CY 6849
BASELINE (1975)	90.970	LACS BM MON IN WELL ON SW COR CRENSHAW BLVD & 109TH ST 19FT S & 70FT W C/L INT MKD (BM 27-69A 1960)	CY 6850
BASELINE (1975)	204.451	LACS BM MON IN WELL @ S END ISLAND 2FT N CB FACE @ NW COR CRENSHAW BLVD & ARBOR VITAE ST 45FT W & 29FT N/O C/L INT MKD (BM 27-67 1953 63)	CY 6852
BASELINE (1975)	214.148	LACS BM MON IN WELL 1FT BK OF CB FACE @ SW COR CRENSHAW BLVD & MANCHESTER BLVD 104FT S & 40FT W C/L INT MKD (BM 27-66 1953)	CY 6853
BASELINE (1975)	224.952	LACE HEX BAR MON IN WELL @ C/L INT 81ST E & 8TH AVE (27-65 CO ENGR-CLA 18-10730)	CY 6855
BASELINE (1975)	242.592	LACE BM MON FL IN CONC 3FT W/O CB S-W COR CRENSHAW BLVD & 80TH ST 38FT W & 45FT S/O C/L INT MKD (24320 FT 13-C 27-64 CO ENGR CLA 18-10770)	CY 6856
BASELINE (1975)	70.353	CS MON 8IN DN NE COR ROSECRANS AVE & OLEANDER ST 39FT N & 71FT E C/L INT MKD (BM 21-1 1952)	CY 6973
BASELINE (1975)	45.916	CS MON 10IN DN 1FT N CB @ NE COR ROSECRANS AVE & WESTERN AVE 179FT E & 41FT N C/L INT MKD (BM 21-9A 1960 RE 5869)	CY 6975
BASELINE (1975)	69.913	BT SPK&L E CB 9FT S BCR @ SE COR ROSECRANS AVE & E BBL ALAMEDA ST 16FT SW OF NW COR CO HEALTH DEP BLDG 300 ROSECRANS AVE	CY 6976

QUAD-YEAR	ELEV	DESCRIPTION (INCLUDE QUAD AND YEAR IN DESCRIPTION)	BM NUMBER
BASELINE (1975)	73.440	CS MON FL IN C B ON NE COR ALAMEDA ST (E BARREL) & EUCLID AVE 45FT N & 27FT E C/L INT MKD (BM 5-19A 1964)	CY 6977
BASELINE (1975)	81.994	L&BN E CB 1FT S BCR @ SE COR ALAMEDA ST E BBL & DIXON AV 40FT S & 20FT E APPROX C/L INT MKD (BM)	CY 6978
BASELINE (1975)	82.499	RDBM TAG IN CONC APRON ON SE COR ALAMEDA ST E BB & DIXON AVE 15FT S & 50FT E APPROX C/L INT MKD (BM)	CY 6979
BASELINE (1975)	95.672	L&BN W CB 1FT N BCR @ NW COR ALAMEDA ST W BBL & SANTA ANA BLVD 30FT W & 105FT N APPROX C/L INT	CY 6980
WATTS (1980)	134.456	L&BN W CB 55FT S BCR @ SW COR EL SEGUNDO BLVD & MAIN ST 135FT S & 35FT W C/L INT	CY 7214
WATTS (1980)	60.925	FC MON IN RD WELL 8IN DN @ C/L INT NORMANDIE AVE & 135TH ST MKD ( LA CO F C DIST )	CY 7216
WATTS (1980)	60.545	L&T W CB 0.6FT S BCR @ SW COR NORMANDIE AVE & 135TH ST 65FT S & 30FT W C/L INT	CY 7217
WATTS (1980)	117.155	L&BN E CB 20FT S/O BCR @ SE COR MAIN ST & 135TH ST 87FT S & 40FT E C/L INT	CY 7218
WATTS (1980)	117.662	RDBM TAG E CB 1FT S BCR @ SE COR MAIN ST & 136TH ST 42FT S & 82FT E C/L INT	CY 7219
WATTS (1980)	149.619	LACE MON 12IN DN @ C/L INT MANCHESTER AVE & BUDLONG AVE	CY 7222
WATTS (1980)	150.045	L&BN S CB 1.5FT W BCR @ SW COR BUDLONG AVE & MANCHESTER AVE 35FT S & 42FT W C/L INT	CY 7223
WATTS (1980)	158.705	L&T W CB 24FT N BCR @ NW COR BUDLONG AVE & 92ND ST 54FT N & 20FT W C/L INT	CY 7224
WATTS (1980)	214.184	L&T E CB NORMANDIE AVE 30FT E C/L & ON C/L PROD 108TH ST	CY 7229
WATTS (1980)	135.848	RDBM TAG W CB 1FT N BCR @ NW COR MAIN ST & 131ST ST 63FT N & 40FT W C/L INT	CY 7231
WATTS (1980)	133.234	RDBM TAG W CB 1FT S BCR @ SW COR MAIN ST & 131ST ST 40FT W & 62FT S C/L INT	CY 7232
WATTS (1980)	129.562	LA CITY DEPT OF PUBLIC WORKS MON FL 2FT W CB 154FT N & 35FT W C/L INT CENTRAL AVE & MANCHESTER AVE (MKD NO 11 M 130.60 ELEV)	CY 7733

QUAD-YEAR	ELEV	DESCRIPTION (INCLUDE QUAD AND YEAR IN DESCRIPTION)	BM NUMBER
WATTS (1980)	128.814	L & SPK 2FT S BCR 59FT S & 35FT E C/L INT CENTRAL AVE & MANCHESTER AVE	CY 7734
BASELINE (1975)	154.635	BRASS MON FL ON C/L FLORENCE AVE & 4FT E C/L E BARREL ALAMEDA ST MKD (CE MON-USE NE COR)	CY 7775
BASELINE (1975)	206.458	LACE MON IN WELL 10IN DN @ C/L INT CRENSHAW BLVD & 76TH ST	CY 7843
BASELINE (1975)	240.347	RDBM TAG 4FT E BCR 18FT N & 69FT E C/L INT CRENSHAW BLVD & 80TH ST	CY 7844
BASELINE (1975)	224.360	L & BN 2FT W BCR 18FT S & 49FT W C/L INT 8TH AVE & 80TH ST TO W	CY 7845
BASELINE (1975)	210.127	L & BR IN E CB 8TH AVE 20FT E/O C/L ON C/L PROD 84TH ST TO W	CY 7846
BASELINE (1975)	209.912	L&BR 2FT S BCR 47FT S & 20FT W/O C/L INT 8TH AVE & 84TH ST TO W	CY 7847
BASELINE (1975)	213.554	L&T 4FT N/O BCR 83FT N & 38FT E/O C/L INT CRENSHAW BLVD & 90TH ST TO THE E	CY 7848
BASELINE (1975)	214.036	CITY OF INGLEWOOD TAG IN CB 38FT E C/L CRENSHAW BLVD ON C/L PROD 90TH ST TO W	CY 7849
BASELINE (1975)	206.240	L & PK 4FT N BCR 33FT N & 38FT E C/L INT CRENSHAW BLVD & ARBOR VITAE ST TO E	CY 7850
BASELINE (1975)	194.815	L & T IN W CB 2FT N BCR OF ISLE 47FT N & 38FT W C/L INT CRENSHAW BLVD & HARDY ST	CY 7851
BASELINE (1975)	194.047	L & DN IN NE COR C B 44FT S & 42FT E C/L INT CRENSHAW BLVD & HARDY ST	CY 7852
BASELINE (1975)	127.443	L&BR IN NE COR C B 75FT N & 42FT E/O C/L INT CRENSHAW BLVD & 104TH ST	CY 7853
BASELINE (1975)	124.690	L&BR 8FT S/O BCR OF ISLE 34FT S & 41FT E/O C/L INT CRENSHAW BLVD & 104TH ST	CY 7854
BASELINE (1975)	91.919	S & L IN E CB 10FT S & 38FT E C/L INT CRENSHAW BLVD & 109TH ST	CY 7855
BASELINE (1975)	78.253	RDBM TAG 13FT S BCR 64FT N & 40FT W C/L INT CRENSHAW BLVD & IMPERIAL HWY	CY 7856
BASELINE (1975)	70.840	L & BR IN CB 40FT E C/L CRENSHAW BLVD @ C/L PROD 116TH ST TO W	CY 7857

QUAD-YEAR	ELEV	DESCRIPTION (INCLUDE QUAD AND YEAR IN DESCRIPTION)	BM NUMBER
BASELINE (1975)	70.105	L&SPK IN W CB 38FT W 65FT S/O C/L INT CRENSHAW BLVD & 116TH ST TO W ( MKD KE-6)	CY 7858
BASELINE (1975)	53.985	RDBM TAG IN CONC BASE TRAFFIC LIGHT 53FT S & 43FT W/O C/L INT CRENSHAW BLVD & BROADWAY	CY 7859
BASELINE (1975)	49.463	LAFC BR CAP MON FL IN N ABUT TO BRIDGE OVER F C CHANNEL 50FT E/O C/L CRENSHAW BLVD & 191FT N/O 132ND ST MKD (BM 114-63 1959)	CY 7860
BASELINE (1975)	46.536	L&BN IN N WALL LAFC CHANNEL 49FT W/O C/L CRENSHAW BLVD & 187FT N C/L 132ND ST	CY 7861
BASELINE (1975)	46.326	RDBM TAG IN W CB 8FT N & 40FT W C/L INT CRENSHAW BLVD & 134TH ST	CY 7862
BASELINE (1975)	47.230	CS BR CAP MON NE COR C B 19FT N & 65FT W C/L INT CRENSHAW BLVD & 139TH ST MKD (BM 27-77A 1965 5869)	CY 7863
BASELINE (1975)	47.178	L&SPK IN N END C B 1FT W/O CB 36FT S & 41FT W/O C/L INT 139TH ST & CRENSHAW BLVD	CY 7864
BASELINE (1975)	72.153	L&BN S CB 38FT S & 35FT E C/L INT ROSECRANS AVE & ARANBE AVE 5FT E/O BCR	CY 7866
BASELINE (1975)	85.409	L&T 9FT W/O BCR 40FT S & 68FT W/O C/L INT ROSECRANS AVE & TAJAUTA AVE	CY 7867
BASELINE (1975)	95.136	S & L @ MCR 51FT N & 30FT E C/L INT ROSECRANS AVE & PARMLEE AVE	CY 7868
BASELINE (1975)	96.631	RDBM TAG IN CONC CB PLANTER 52FT S & 6FT E C/L INT ROSECRANS AVE & PARMLEE AVE	CY 7869
BASELINE (1975)	113.956	RDBM TAG 5FT N BCR 65FT S & 41FT E C/L INT ROSECRANS AVE & AVALON BLVD	CY 7870
BASELINE (1975)	112.840	RDBM TAG 4FT W BCR 40FT S & 80FT W C/L INT ROSECRANS AVE & AVALON BLVD	CY 7871
BASELINE (1975)	105.497	RDBM TAG 4FT S BCR 86FT S & 32FT E C/L INT ROSECRANS AVE & SAN PEDRO ST	CY 7872
BASELINE (1975)	106.695	RDBM TAG 4FT W/O BCR 40FT S & 64FT W C/L INT ROSECRANS AVE & SAN PEDRO ST	CY 7873
BASELINE (1975)	112.425	RDBM TAG 3FT E BCR 40FT N & 76FT E C/L INT ROSECRANS AVE & MAIN ST	CY 7874

QUAD-YEAR	ELEV	DESCRIPTION (INCLUDE QUAD AND YEAR IN DESCRIPTION)	BM NUMBER
BASELINE (1975)	112.179	LACS MON IN WELL 8IN DN 2FT W CB 74FT S & 42FT W C/L INT ROSECRANS AVE & MAIN ST (MKD BM 21-5A 1970)	CY 7875
BASELINE (1975)	114.688	L & T @ MCR 52FT S & 46FT E C/L INT ROSECRANS AVE & BROADWAY	CY 7876
BASELINE (1975)	113.944	RDBM TAG 4FT S BCR 80FT S & 40FT W C/L INT ROSECRANS AVE & BROADWAY	CY 7877
BASELINE (1975)	100.681	RDBM TAG 2FT S BCR 65FT S & 40FT E C/L INT ROSECRANS AVE & FIGUEROA ST	CY 7878
BASELINE (1975)	60.220	RDBM TAG 3FT W BCR 42FT S & 48FT W C/L INT ROSECRANS AVE & VERMONT AVE ( W BBL)	CY 7879
BASELINE (1975)	52.027	RDBM TAG 1FT E BCR 40FT S & 45FT E C/L INT ROSECRANS AVE & BUOLONG AVE	CY 7880
BASELINE (1975)	51.420	RDBM TAG 1FT S BCR 66FT S & 18FT W C/L INT ROSECRANS AVE & BUOLONG AVE	CY 7881
BASELINE (1975)	47.251	RDBM TAG 40FT S/O BCR 108FT S & 30FT E/O C/L INT ROSECRANS AVE & NORMANDIE AVE	CY 7882
BASELINE (1975)	47.003	RDBM TAG 3FT E BCR 40FT S & 62FT W C/L INT ROSECRANS AVE & NORMANDIE AVE	CY 7883
BASELINE (1975)	45.939	RDBM TAG 23FT E BCR 40FT S & 66FT E C/L INT ROSECRANS AVE & HALLDALE AVE	CY 7884
BASELINE (1975)	45.765	RDBM TAG IN W CB @ N END C B 5FT S BCR 71FT S & 18FT W C/L INT ROSECRANS AVE & HALLDALE AVE	CY 7885
BASELINE (1975)	45.179	RDBM TAG 1FT N BCR 64FT S & 18FT E C/L INT ROSECRANS AVE & DENKER AVE	CY 7886
BASELINE (1975)	45.729	RDBM TAG 5FT W BCR 40FT S & 49FT W C/L INT ROSECRANS AVE & DENKER AVE	CY 7887
BASELINE (1975)	46.769	L & BN 4FT S BCR 35FT W C/L WESTERN AVE & 67FT S C/L ROSECRANS AVE (MKD BM)	CY 7888
BASELINE (1975)	102.634	RDBM TAG 3FT N BCR 94FT S & 38FT E C/L INT CENTRAL AVE & ROSECRANS AVE	CY 7889
WATTS (1980)	98.502	L & ENG TAG 1FT N BCR 47FT N & 38FT E C/L INT CENTRAL AVE & PIRU ST	CY 7890
WATTS (1980)	97.477	L & BN 2FT N BCR 56FT N & 80FT W C/L INT CENTRAL AVE (SER RD) & 135TH ST	CY 7891

QUAD-YEAR	ELEV	DESCRIPTION (INCLUDE QUAD AND YEAR IN DESCRIPTION)	BM NUMBER
WATTS (1980)	94.298	L & T 15FT S BCR 72FT S & 38FT E C/L INT CENTRAL AVE & 131ST ST (MKD S D 523)	CY 7892
WATTS (1980)	93.693	RDBM TAG 5FT S BCR OF ISL @ N END C B 44FT S & 38FT W C/L INT CENTRAL AVE & 131ST ST TO W	CY 7893
WATTS (1980)	92.792	RDBM TAG 5FT S BCR 48FT S & 40FT W C/L INT CENTRAL AVE & 118TH ST	CY 7894
WATTS (1980)	92.814	RDBM TAG 5FT E BCR 15FT N & 65FT E C/L INT CENTRAL AVE & 118TH ST	CY 7895
WATTS (1980)	153.349	L & T NR MCR 25FT N & 24FT W C/L INT BUDLONG AVE & 89TH ST	CY 7924
WATTS (1980)	158.744	L & T NR MCR 25FT S & 25FT W C/L INT BUDLONG AVE & 92ND ST	CY 7926
WATTS (1980)	160.084	RDBM TAG 3FT E BCR 20FT S & 43FT E C/L INT BUDLONG AVE & 95TH ST	CY 7928
WATTS (1980)	167.043	L & BN 30FT S BCR 80FT S & 20FT W C/L INT CENTURY BLVD & BUDLONG AVE	CY 7930
WATTS (1980)	189.624	RDBM TAG 2FT W BCR 30FT N & 48FT E C/L INT CENTURY BLVD & NORMANDIE AVE	CY 7931
WATTS (1980)	196.993	RDBM TAG 2FT E BCR 15FT S & 52FT E C/L INT NORMANDIE AVE & 104TH ST	CY 7933
WATTS (1980)	213.530	RDBM TAG 1FT W BCR 15FT N & 55FT W C/L INT NORMANDIE AVE & 110TH PL	CY 7936
WATTS (1980)	212.714	L & T IN CB 30FT E C/L NORMANDIE AVE ON C/L PROD 110TH PL	CY 7937
WATTS (1980)	201.099	RDBM TAG 1FT S BCR 60FT S & 30FT W C/L INT NORMANDIE AVE & IMPERIAL HWY	CY 7938
WATTS (1980)	170.025	L & BN IN W CB 4FT N/O SPRR 30FT W C/L INT NORMANDIE AVE & SPRR (0.3MI S/O IMPERIAL HWY)	CY 7939
WATTS (1980)	170.672	L & T 0.5FT S BCR OF DRWY 40FT S & 30FT E C/L INT NORMANDIE AVE & SPRR (0.3MI S/O C/L IMPERIAL HWY)	CY 7940
WATTS (1980)	192.273	RDBM TAG 10FT W BCR 32FT N & 77FT W C/L INT NORMANDIE AVE & 120TH ST	CY 7941
WATTS (1980)	151.946	L & T 1FT W BCR 20FT N & 56FT W C/L INT NORMANDIE AVE & 125TH ST	CY 7942



QUAD-YEAR	ELEV	DESCRIPTION (INCLUDE QUAD AND YEAR IN DESCRIPTION)	BM NUMBER
WATTS (1980)	153.466	RDBM TAG 2FT W BCR 20FT S & 53FT E C/L INT NORMANDIE AVE & 125TH ST	CY 7943
WATTS (1980)	87.190	RDBM TAG 4FT N BCR @ S END C B 58FT N & 30FT E C/L INT NORMANDIE AVE & 132ND ST	CY 7944
WATTS (1980)	85.307	RDBM TAG 2FT E BCR 30FT S & 57FT E C/L INT NORMANDIE AVE & 132ND ST	CY 7945
WATTS (1980)	50.183	RDBM TAG IN E CB @ S EDGE C B 47FT N & 30FT E C/L INT NORMANDIE AVE & 139TH ST	CY 7946
WATTS (1980)	50.262	S & L 12FT S BCR 54FT S & 30FT W C/L INT NORMANDIE AVE & 139TH ST	CY 7947
WATTS (1980)	146.352	RDBM TAG 4FT N BCR 72FT N & 40FT E C/L INT EL SEGUNDO BLVD & BROADWAY	CY 7960
WATTS (1980)	105.249	L & BR 8FT W BCR DF ISLE 40FT S & 45FT W C/L INT IMPERIAL HWY & CASIMIR AVE	CY 7969
WATTS (1980)	105.643	L & BR 5FT E BCR DF ISLE 40FT S & 41FT E C/L INT IMPERIAL HWY & CASIMIR AVE	CY 7970
WATTS (1980)	116.600	RDBM TAG IN S CB SERVICE RD 2FT W BCR 80FT S & 124FT W C/L INT IMPERIAL HWY & VAN NESS AVE	CY 7971
WATTS (1980)	151.652	RDBM TAG IN S CB SERVICE RD 4FT W BCR 80FT S & 40FT W C/L INT IMPERIAL HWY & WILTON PL	CY 7972
WATTS (1980)	155.612	RDBM TAG 3FT E BCR 38FT S & 58FT E C/L INT IMPERIAL HWY & WILTON PL	CY 7973
WATTS (1980)	201.389	RDBM TAG 3FT S ECR 73FT S & 42FT W C/L INT IMPERIAL HWY & WESTERN AVE	CY 7974
WATTS (1980)	203.040	L & BN 30FT E BCR 40FT S & 110FT E C/L INT IMPERIAL HWY & WESTERN AVE MKD (BM)	CY 7975
WATTS (1980)	210.021	RDBM TAG 5FT W BCR 40FT N & 50FT W C/L INT IMPERIAL HWY & DENKER AVE	CY 7976
WATTS (1980)	173.957	FLT HD SPK 3FT N BCR 55FT N & 28FT E C/L INT IMPERIAL HWY & HOOVER ST	CY 7980
WATTS (1980)	174.533	L & T2.5FT E BCR 34FT S & 43FT E C/L INT IMPERIAL HWY & HOOVER ST	CY 7981
WATTS (1980)	141.062	BT SPK 12FT E BCR @ W END C B 30FT N & 48FT E C/L INT IMPERIAL HWY & BROADWAY	CY 7982

QUAD-YEAR	ELEV	DESCRIPTION (INCLUDE QUAD AND YEAR IN DESCRIPTION)	BM NUMBER
WATTS (1980)	128.420	FLT HD SPK 30FT S BCR 82FT S & 25FT W C/L INT IMPERIAL HWY & MAIN ST	CY 7983
WATTS (1980)	127.088	RDBM TAG 4FT E BCR OF ISLE 40FT S & 75FT E C/L INT IMPERIAL HWY & MAIN ST	CY 7984
WATTS (1980)	123.807	RDBM TAG 1FT S BCR 32FT W C/L SAN PEDRO ST & 10FT S C/L IMPERIAL HWY PROD	CY 7985
WATTS (1980)	122.835	RDBM TAG 16FT E BCR 40FT S & 66FT E C/L INT IMPERIAL HWY & SAN PEDRO ST	CY 7986
WATTS (1980)	102.336	S & L IN C B WALL 6FT W BCR 55FT N & 56FT W C/L INT IMPERIAL HWY & WADSWORTH AVE	CY 7987
WATTS (1980)	101.592	RDBM TAG 4FT E BCR 44FT S & 79FT E C/L INT IMPERIAL HWY & WADSWORTH AVE	CY 7988
WATTS (1980)	94.101	ST DIV HWYS STAN STEEL PLATE & W 20FT N ECR 82FT N & 19FT W C/L INT IMPERIAL HWY & COMPTON AVE N	CY 7989
WATTS (1980)	93.120	FLT HD SPK 9FT N ECR IN N END C B 69FT N & 10FT W C/L INT IMPERIAL HWY & GRANDEE AVE	CY 7990
WATTS (1980)	91.851	L & BN 41FT W BCR 40FT S & 112FT W C/L INT IMPERIAL HWY & WILMINGTON AVE	CY 7991
WATTS (1980)	92.253	RDBM TAG 6FT S ECR 74FT S & 40FT E C/L INT IMPERIAL HWY & WILMINGTON AVE	CY 7992
WATTS (1980)	89.455	FLT HD SPK 10FT W BCR IN W END C B 40FT S & 38FT W C /L INT IMPERIAL HWY & LOU DILLON AVE	CY 7993
WATTS (1980)	90.181	L & T IN N CB 40FT N & 34FT W C/L INT IMPERIAL HWY & LOU DILLON AVE	CY 7994
WATTS (1980)	113.640	L & BN 9FT S BCR 64FT S & 40FT E C/L INT MAIN ST & 140TH ST	CY 8006
WATTS (1980)	152.288	L & N @ MGR 23FT S & 28FT E C/L INT BROADWAY & 117TH ST	CY 8009
WATTS (1980)	129.164	L & CE TAG IN CB 37FT N C/L FIRESTONE BLVD ON C/L PROD OF ZAMORA AVE	CY 8013
WATTS (1980)	129.015	L & T IN CB RET 10FT E BCR 39FT S & 28FT W C/L INT FIRESTONE BLVD & ZAMORA AVE	CY 8014
WATTS (1980)	128.906	L & T 1FT E BCR 35FT N & 56FT E C/L INT CENTRAL AVE & MANCHESTER AVE	CY 8015

QUAD-YEAR	ELEV	DESCRIPTION (INCLUDE QUAD AND YEAR IN DESCRIPTION)	BM NUMBER
WATTS (1980)	129.357	L & T 1FT N BCR 50FT N & 15FT W C/L INT MCKINLEY AVE & MANCHESTER AVE	CY 8017
WATTS (1980)	129.585	S&L 13FT W/O BCR 35FT S & 46FT W/O C/L INT MCKINLEY PL & MANCHESTER AVE	CY 8018
WATTS (1980)	131.899	S & L 20FT N ECR 70FT N & 33FT W C/L INT MANCHESTER AVE & AVALON BLVD	CY 8019
WATTS (1980)	131.647	S & L 1FT W BCR 35FT S & 53FT W C/L INT MANCHESTER AVE & AVALON BLVD	CY 8020
WATTS (1980)	130.556	S & L 10FT E BCR 35FT N & 64FT E C/L INT MANCHESTER AVE & SAN PEDRO ST	CY 8021
WATTS (1980)	130.270	S & L @ MCR 45FT S & 35FT W C/L INT MANCHESTER AVE & SAN PEDRO ST	CY 8022
WATTS (1980)	131.631	CUT SPK IN NE COR C B 68FT N 31FT E C/L INT MANCHESTER AVE & MAIN ST	CY 8023
WATTS (1980)	130.897	L & T 14FT W BCR 35FT S & 56FT W C/L INT MANCHESTER AVE & MAIN ST	CY 8024
WATTS (1980)	130.548	CUT SPK IN NW COR C B 39FT N & 68FT E C/L INT MANCHESTER AVE & BROADWAY	CY 8025
WATTS (1980)	130.900	L & N @ MCR 43FT S & 44FT W C/L INT MANCHESTER AVE & BROADWAY	CY 8026
WATTS (1980)	130.399	CUT SPK IN NW COR C B 39FT N & 62FT E C/L INT MANCHESTER AVE & FIGUEROA ST	CY 8027
WATTS (1980)	130.142	L & T 1FT S ECR 61FT S & 32FT W C/L INT MANCHESTER AVE & FIGUEROA ST	CY 8028
WATTS (1980)	132.839	SQ SPK & L 15FT S ECR 70FT S & 24FT E C/L INT MANCHESTER AVE & HOOVER ST TO N	CY 8029
WATTS (1980)	133.389	L & T 40FT W BCR 35FT S & 75FT W C/L INT MANCHESTER AVE & HOOVER ST TO S	CY 8030
WATTS (1980)	137.866	RDBM TAG IN E CB 51FT S & 35FT E/O C/L INT E BBL MANCHESTER AVE & VERMONT AVE	CY 8031
WATTS (1980)	139.712	S&L IN W CB 70FT S & 52FT W/O C/L INT W BBL MANCHESTER AVE & VERMONT AVE	CY 8032
WATTS (1980)	162.912	S & L 15FT S ECR 71FT S & 27FT E C/L INT MANCHESTER AVE & NORMANDIE AVE	CY 8033

QUAD-YEAR	ELEV	DESCRIPTION (INCLUDE QUAD AND YEAR IN DESCRIPTION)	BM NUMBER
WATTS (1980)	163.524	RDBM TAG 1FT E BCR 35FT S & 55FT W C/L INT MANCHESTER AVE & NORMANDIE AVE	CY 8034
WATTS (1980)	174.412	RDBM TAG IN NE COR C B 64FT S & 24FT E C/L INT MANCHESTER AVE & DENKER AVE	CY 8035
WATTS (1980)	187.473	RDBM TAG 2FT E BCR 35FT S & 58FT E C/L INT MANCHESTER AVE & WESTERN AVE	CY 8037
WATTS (1980)	188.694	RDBM TAG 2.5FT W BCR 35FT N & 58FT W C/L INT MANCHESTER AVE & WESTERN AVE	CY 8038
WATTS (1980)	203.781	FLT HD SPK 10FT N ECR 58FT N & 18FT E C/L INT MANCHESTER AVE & GRAMERCY PL	CY 8039
WATTS (1980)	214.084	L & N 5FT W BCR 35FT S & 42FT W C/L INT MANCHESTER AVE & VAN NESS AVE	CY 8041
WATTS (1980)	219.389	S & L 4FT N ECR 68FT N & 18FT E C/L INT MANCHESTER AVE & FIFTH AVE	CY 8042
WATTS (1980)	219.430	RDBM TAG 3FT W BCR 38FT S & 33FT W C/L INT MANCHESTER AVE & FIFTH AVE	CY 8043
BASELINE (1975)	110.932	L & T IN S CB ROSECRANS (N CB ISLE) 42.5FT S & 52FT W C/L INT ROSECRANS AVE & CAHITA AVE	CY 8191
BASELINE (1975)	127.689	L & T 28FT E C/L ALAMEDA ST ON C/L PROD 85TH ST	CY 8797
BASELINE (1975)	51.035	LACS BM MON IN SLY WALL LAGUNA DOMINGUEZ CHANNEL 1FT SW OF SW COR BRIDGE NO 1276 SW COR ROSECRANS AVE & CRENSHAW BLVD 241FT S & 43FT W/O C/L INT MKD (21- 12A 1964 RE 5869)	CY 9269
BASELINE (1975)	51.979	L AFC BR CAP MON 8IN DN 173FT E/O C/L CRENSHAW BLVD 40FT N/O INT BROADWAY 31FT N/O C/L P E RR TRACKS & 19FT W/O W SIDE DOMINGUEZ CHANNEL MKD (114-RW-111 1964 27-74A CD ENGR)	CY 9270
BASELINE (1975)	170.516	L&PK IN CB RET NE COR CRENSHAW BLVD & CENTURY BLVD 66FT E & 38FT N/O C/L INT 2FT W/O BCR	CY 9271
BASELINE (1975)	207.909	RDBM TAG S CB 1FT E/O BCR S-E COR CRENSHAW BLVD & 76TH ST TO THE E 51FT E & 18FT S/O C/L INT	CY 9272
BASELINE (1975)	71.327	RDBM TAG 5FT W BCR INTO RET @ SW COR ROSECRANS AVE & ALAMEDA ST E BBL 210FT S & 33FT W/O C/L	CY 9313
BASELINE (1975)	78.029	RAMSET 2FT S BCR @ SE COR ALAMEDA ST E BBL 24FT E/O & 52FT S/O C/L INT BANNING ST	CY 9314

QUAD-YEAR	ELEV	DESCRIPTION (INCLUDE QUAD AND YEAR IN DESCRIPTION)	BM NUMBER
BASELINE (1975)	87.522	RAMSET IN CTR CB RET @ SE COR ALAMEDA ST E BBL & LYNWOOD RD 20FT E & 32FT S/O C/L INT	CY 9315
BASELINE (1975)	112.872	RDBM TAG 4FT S BCR @ SW COR E BBL ALAMEDA ST 18FT E & 37FT S/O C/L INT KANSAS AVE	CY 9317
BASELINE (1975)	118.035	RDBM TAG 4FT S BCR @ SE COR E BBL ALAMEDA ST IN NLY WALL C B 19FT E & 45FT S C/L INT SOUTHERN AV	CY 9318
BASELINE (1975)	124.806	L&T 6FT S BCR IN CONC CB @ NE COR ALAMEDA ST & FIRESTONE BLVD 29FT E & 47FT N/O C/L INT	CY 9319
BASELINE (1975)	139.716	CS TAG IN CTR CONC C B @ SW COR E BBL ALAMEDA ST & NADEAU ST 21FT E & 34FT S/O C/L INT	CY 9320
BASELINE (1975)	138.826	CS MON IN WELL 30FT E & 15FT S/O APPROX C/L INT W BBL ALAMEDA ST & NADEAU ST USE W EDGE	CY 9321
BASELINE (1975)	149.288	L&T 28FT E C/L ALAMEDA ST NEAR C/L PROD 76TH ST	CY 9322
BASELINE (1975)	161.108	L&T 20FT W C/L E BBL ALAMEDA ST ON OR NEAR C/L PROD ZOE AVE	CY 9323
BASELINE (1975)	166.051	CS MON FL IN CONC BASE SIGNAL LIGHT 27FT E & 45 FT S C/L INT W BBL ALAMEDA ST & GAGE AVE MKD ( BM 5-75 1964)	CY 9324
BASELINE (1975)	71.200	L&BD @ MCR @ NW COR ROSECRANS AVE & GLEANDER AVE 21FT W & 40FT N/O C/L INT	CY 9325
BASELINE (1975)	62.570	RDBM TAG 1FT E/O BCR @ NE COR ROSECRANS AVE & E BBL VERMONT AVE 42FT N & 50FT E/O C/L INT	CY 9326
WATTS (1980)	153.471	L&T @ CTR CB RET @ SW COR BUDLONG AVE & 89TH ST 26FT W & 24FT S/O C/L INT	CY 9625
WATTS (1980)	166.211	L&T 5FT W/O BCR @ SE COR CENTURY BLVD & BUDLONG AVE 39FT S & 37FT E/O C/L INT BUDLONG AVE TO SO	CY 9626
WATTS (1980)	214.403	RDBM TAG 2FT S/O BCR @ SW COR NORMANDIE AVE & 108TH ST 30FT W & 55FT S/O C/L INT	CY 9627
WATTS (1980)	119.286	RDBM TAG 6FT S/O BCR @ SW COR NORMANDIE AVE & EL SEGUNDO BLVD 30FT W & 70FT S/O C/L INT	CY 9628
WATTS (1980)	97.717	RAMSET CTR CB RET @ NE COR IMPERIAL HWY & CENTRAL AVE 53FT N & 44FT E/O C/L INT	CY 9632
WATTS (1980)	198.192	L&LACE TAG 5FT S/O BCR OF ISLAND 36FT E & 51FT S/O C/L INT VERMONT AVE ( W BBL ) & IMPERIAL HWY	CY 9633

QUAD-YEAR	ELEV	DESCRIPTION (INCLUDE QUAD AND YEAR IN DESCRIPTION)	BM NUMBER
WATTS (1980)	187.782	L&LACE TAG 38FT N/O C/L IMPERIAL HWY ON C/L PROD BUDLONG AVE TO THE S	CY 9634
WATTS (1980)	207.551	RDBM TAG 2FT E/O BCR @ NE COR IMPERIAL HWY & DENKER AVE 38FT N & 47FT E/O C/L INT	CY 9635
WATTS (1980)	213.216	L&PK 42FT E/O BCR @ SE COR MANCHESTER AVE & VAN NESS AVE 82FT E & 35FT S/O C/L INT	CY 9636
WATTS (1980)	120.285	RDBM TAG 3FT W/O BCR @ SW COR 92ND ST & HOLMES AVE 38FT W & 32FT S/O C/L INT	CY 9641
WATTS (1980)	120.349	RDBM TAG 3FT W/O BCR @ NW COR 92ND ST & HOLMES AVE 32FT N & 48FT W/O C/L INT	CY 9642
WATTS (1980)	115.693	RDBM TAG 3FT W/O BCR @ SW COR 92ND ST & HICKORY ST 50FT W & 32FT S/O C/L INT	CY 9643
WATTS (1980)	115.440	RDBM TAG 3FT E/O BCR @ SE COR 92ND ST & HICKORY ST 48FT E & 32FT S/O C/L INT	CY 9644
BASELINE (1975)	214.987	RDBM TAG E CB 2IN N BCR 38FT E/O C/L CRENSHAW BLVD & 76FT N/O C/L MANCHESTER BLVD	CY 10108
WATTS (1980)	174.555	SPK 3FT W BCR 35FT S & 42FT W/O C/L INT MANCHESTER AVE & DENKER AVE	CY 10109
WATTS (1980)	121.728	RDBM TAG IN E CB 1FT N BCR 32FT E/O C/L COMPTON AVE & 58FT N/O C/L 92ND ST	CY 10110
WATTS (1980)	121.140	RDBM TAG IN S CB 3FT E BCR 32FT S/O C/L 92ND ST & 50FT E/O C/L COMPTON AVE	CY 10111
WATTS (1980)	97.530	L&SPK 5FT S BCR 71FT S & 40FT E/O C/L INT CENTRAL AVE & IMPERIAL HWY	CY 10112
WATTS (1980)	158.107	RDBM TAG IN N END C B @ SW COR BROADWAY & 120TH ST (INT TO SO) 52FT S & 55FT E/O C/L INT	CY 10113
WATTS (1980)	158.340	RDBM TAG IN N CB 7FT W BCR @ NW COR BROADWAY & 120TH ST (INT TO NO) 28FT N & 45FT W/O C/L INT	CY 10114